



Corporate Campus
Dover, New Hampshire
www.measuredprogress.org
603.749.9102 • fax 603.749.6398

Mailing Address
P.O. Box 1217
Dover, NH 03821-1217

Shipping & Receiving
50 Education Way
Dover, NH 03820-5814

Dear Psychometric Society Member:

On behalf of Psychometric Society President Paul DeBoeck and the Organizing Committee, thank you for registering for IMPS2008. This message will serve to confirm your registration. This letter is part of the pre-conference registration packet, and in this packet you will find a variety of important information about the conference. I encourage you to print out this entire packet and bring it with you to New Hampshire. Enclosed in this packet are details about:

- Transportation to the conference center
- A map of the University of New Hampshire
- Details about the excursions
- Information about local restaurants and attractions

The IMPS2008 conference will be held at the Holloway Conference Center located at 75 Main Street, Durham, NH 03824, and the University of New Hampshire in Durham. I believe you will find this conference facility very comfortable with several important amenities:

- LCD projectors are available; we do strongly encourage you to bring your own laptop computer. There will be faculty onsite to help with presentation setup.
- On site breakfast & lunch (\$10 USD for each meal)
- Wireless internet connection throughout the conference facility

I encourage you to read through the information we've provided you, and feel free to email our helpdesk if you have any questions:

- imps2008@measuredprogress.org

We look forward to seeing you in New Hampshire and to a having a fun and productive IMPS2008 meeting.

Sincerely,

A handwritten signature in black ink, appearing to read "Michael L. Nering", with a stylized flourish at the end.

Michael L. Nering, Ph. D.
Director of Psychometrics

IMPS 2008 Conference Shuttle

The IMPS 2008 Conference Shuttle is the most direct and affordable method of transportation between Logan Airport, Boston, MA and Congreve Hall at the University of New Hampshire, Durham, NH

Shuttle Schedule

From Logan to UNH:

Departs Logan Airport, *Terminal E*
5:00pm

June 28, 2008

Arrives Congreve Hall UNH (Approx. Times)
6:30pm

Departs Logan Airport, *Terminal E*
12:00pm
3:30pm
7:00pm

June 29, 2008

Arrives Congreve Hall UNH (Approx. Times)
1:30pm
5:00pm
8:30pm

From UNH to Logan:

Departs Congreve Hall UNH
9:00am
12:30pm
4:00pm

July 3, 2008

Arrives Logan Airport, *Terminal E* (Approx. Times)
10:30am
2:00pm
5:30pm

Logan Airport Terminal E Pick up

Proceed to the end of the terminal where the check-in booths are, then go outside, Outermost curb area. Look for a big yellow school bus with Psychometrics Society signs attached. There will be an attendant from the society on the bus to make sure everyone gets on the bus.

School Bus



Directions and Transportation to Conference Site

Transportation options from Boston/Logan Airport:

Depending on arrival time and hotel location there are a number of transportation options to consider.

To Durham, Dover, or Portsmouth, NH

****Recommended carrier is
Flightline Inc.****

www.flightlineinc.com

This is a shared or private shuttle service that picks up at Logan and services all of Seacoast NH.



****Advanced registration is strongly suggested****

Other Transportation options include:



C&J Trailways, a local bus company www.cjtrailways.com

C&J picks up right at Logan Airport and has stops in all three cities, but includes bus changes to get to Dover or Durham. Follow the attached link for schedules and fares.



The Downeaster Amtrack Rail Service

www.thedowneaster.com.

Directions to Psychometrics Society Meeting at UNH

From I-95 North (Mass.), take Exit 4 (in NH) (left hand exit) to the Spaulding Turnpike (Route 16N), then take Exit 6W (Route 4 West) towards Durham to the Exit for Route 155A. Follow direction to the Visitor Information Center.

From I-95 South (Maine), take Exit 5 (in NH) to the Spaulding Turnpike (Route 16N), then take Exit 6W (Route 4 West) towards Durham to the Exit for Route 155A. Follow direction to the Visitor Information Center.

From the West, take route 101 east to Exit 7 (Route 125 North). Follow Route 125 North to the traffic circle. Take Route 4 East to the Durham Exit (2 miles) (Route 155A). Follow directions to the Visitor Information Center.

Parking at UNH

For those who wish to drive to the meeting site, you will have the option of purchasing parking passes. The parking passes are priced at \$10.00 per day. The paid parking is located at C lot, and can be paid daily at the lot itself (cash only) or in advance during check-in.

On-Site Conference Registration

On-Site Housing Check-in Process: For members staying at the UNH accommodation facilities they will go through a check-in process at the accommodation building. UNH will staff the check-in desks through 10:00pm. If you know ahead of time that you will be arriving later than 10:00pm, please contact the UNH housing office at 603-862-1900 to make check-in arrangements.

Conference On-Site Registration Desk: Staff members will be at the on-site conference registration desk throughout the duration of the conference. During the on-site registration, members will be given a name tag and a Conference Packet. The registration desk will be outside the meeting rooms and will serve as our conference headquarters. Members will be asked to report to this desk in the event that they have questions or need additional services.



On-campus Housing

Conference Registration

Banquet

Parking

New Hampshire Hall

McLaughlin

Jessie Doe

Stillings

Nesmith

Taylor

Kendall

Morrill

Scott

Craft

Stoke

Petee

Library

James

Congreve

Smith

Schofield

E. Demeritt House

Ritzman

Combined Heat & Power Plant

Service

Hewitt

Demeritt

Murkland

Thompson Hall

President's House

Hersey

Batchelor

Robinson

Chase Ocean Engineering

Gregg

Zais

Telecom

Conant

Dimond Library

Holloway Commons

Hamilton Smith

Health Services

Janetos

Town Lot

Waterworks Rd.

Colovos Rd.

Service Rd.

College Rd.

Main Street

Garrison Ave.

South Dr.

Arts Way

Mitchell Way

College Rd.

Mill Rd.

DeMeritt Cir.

SERC

Forest Park

Paul Creative Arts Center

Horton

Randall

Devine

Alexander

C Lot

Grounds & Roads

SERC

Forest Park

Paul Creative Arts Center

Horton

Randall

Devine

Alexander

C Lot

Grounds & Roads

SERC

Forest Park

Paul Creative Arts Center

Horton

Randall

Devine

Alexander

C Lot

Grounds & Roads

SERC

Forest Park

Paul Creative Arts Center

Horton

Randall

Devine

Alexander

C Lot

Grounds & Roads

SERC

Forest Park

Paul Creative Arts Center

Horton

Randall

Devine

Alexander

C Lot

Grounds & Roads

SERC

Forest Park

Paul Creative Arts Center

Horton

Randall

Devine

Alexander

C Lot

Grounds & Roads

SERC

Forest Park

Paul Creative Arts Center

Horton

Randall

Devine

Alexander

C Lot

Grounds & Roads

SERC

Forest Park

Paul Creative Arts Center

Horton

Randall

Devine

Alexander

C Lot

Grounds & Roads

SERC

Forest Park

Paul Creative Arts Center

Horton

Randall

Devine

Alexander

C Lot

Grounds & Roads

SERC

Forest Park

Paul Creative Arts Center

Horton

Randall

Devine

Alexander

C Lot

Grounds & Roads

SERC

Forest Park

Paul Creative Arts Center

Horton

Randall

Devine

Alexander

C Lot

Grounds & Roads

SERC

Forest Park

Paul Creative Arts Center

Horton

Randall

Devine

Alexander

C Lot

Grounds & Roads

SERC

Forest Park

Paul Creative Arts Center

Horton

Randall

Devine

Alexander

C Lot

Grounds & Roads

SERC

Forest Park

Paul Creative Arts Center

Horton

Randall

Devine

Alexander

C Lot

Grounds & Roads

SERC

Forest Park

Paul Creative Arts Center

Horton

Randall

Devine

Alexander

C Lot

Grounds & Roads

SERC

Forest Park

Paul Creative Arts Center

Horton

Randall

Devine

Alexander

C Lot

Grounds & Roads

SERC

Forest Park

Paul Creative Arts Center

Horton

Randall

Devine

Alexander

C Lot

Grounds & Roads

SERC

Forest Park

Paul Creative Arts Center

Horton

Randall

Devine

Alexander

C Lot

Grounds & Roads

SERC

Forest Park

Paul Creative Arts Center

Horton

Randall

Devine

Alexander

C Lot

Grounds & Roads

SERC

Forest Park

Paul Creative Arts Center

Horton

Randall

Devine

Alexander

C Lot

Grounds & Roads

SERC

Forest Park

Paul Creative Arts Center

Horton

Randall

Devine

Alexander

C Lot

Grounds & Roads

SERC

Forest Park

Paul Creative Arts Center

Horton

Randall

Devine

Alexander

C Lot

Grounds & Roads

SERC

Forest Park

Paul Creative Arts Center

Horton

Randall

Devine

Alexander

C Lot

Grounds & Roads

SERC

Forest Park

Paul Creative Arts Center

Horton

Randall

Devine

Alexander

C Lot

Grounds & Roads

SERC

Forest Park

Paul Creative Arts Center

Horton

Randall

Devine

Alexander

C Lot

Grounds & Roads

SERC

Forest Park

Paul Creative Arts Center

Horton

Randall

Devine

Alexander

C Lot

Grounds & Roads

SERC

Forest Park

Paul Creative Arts Center

Horton

Randall

Devine

Alexander

C Lot

Grounds & Roads

SERC

Forest Park

Paul Creative Arts Center

Horton

Randall

Devine

Alexander

C Lot

Grounds & Roads

SERC

Forest Park

Paul Creative Arts Center

Horton

Randall

Devine

Alexander

C Lot

Grounds & Roads

SERC

Forest Park

Paul Creative Arts Center

Horton

Randall

Devine

Alexander

C Lot

Grounds & Roads

SERC

Forest Park

Paul Creative Arts Center

Horton

Randall

Devine

Alexander

C Lot

Grounds & Roads

SERC

Forest

University Conferences & Catering Floor Plans

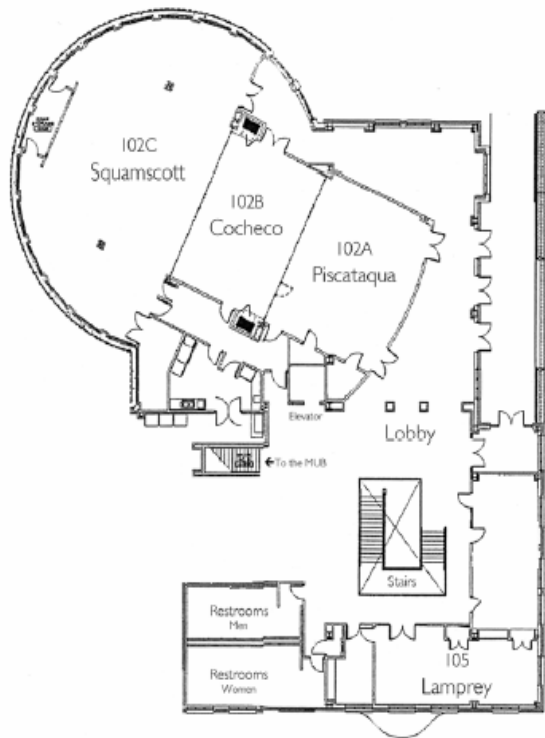

**Holloway Commons
First Floor
Conference Rooms**

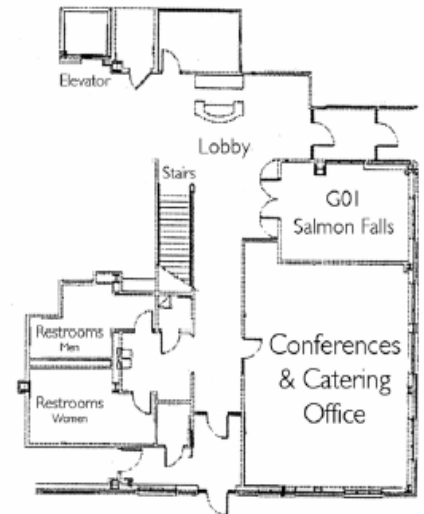
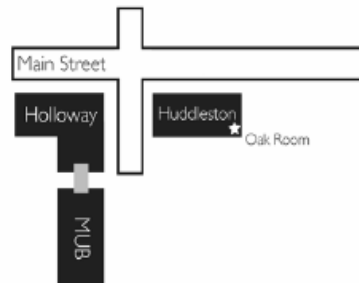

**Holloway Commons
Ground Floor**

University Conferences & Catering Floor Plans

Memorial Union Building Second Floor Food Court & Strafford Room

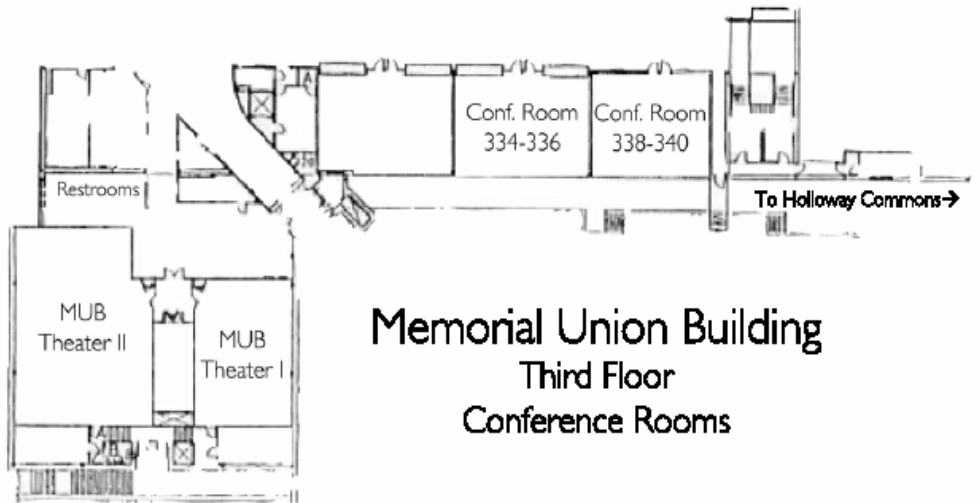
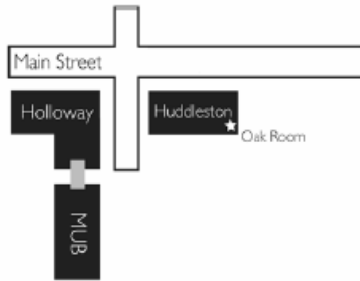
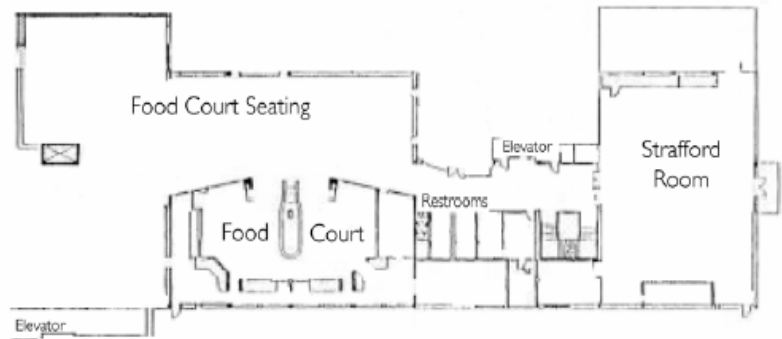

Memorial Union Building Third Floor Conference Rooms

Things to do in Durham, New Hampshire, and surrounding towns

Durham offers a full range of recreational opportunities for residents and visitors alike. As a true seacoast waterfront community, Durham offers a wide variety of the best in boating, sailing, fishing, and swimming.

Numerous parks and recreational areas dot the town, and through careful planning, features like bike lanes and trails are being added constantly to enhance enjoyment of Durham's spectacular landscape.



College Woods at UNH – College Woods is located on the west side of the main campus. It comprises approximately 250 acres of woods, streams, and small fields. College Woods is the oldest and most intensively used University property for walking, running, and general natural relaxation recreation. It is not uncommon to see walkers, runners, and classes all in one brief stroll through the woods.

Adams Point – a beautiful estuary located 80 acre area with hiking trails; located between Great and Little Bays and accessed from Durham Point Road, off of 108 south of town, where families and hikers bring picnic baskets and binoculars to spend a day enjoying the scenery, catching glimpses of wildlife (horseshoe crabs and great blue herons abound), and walking trails through fields, woods, and rocky beaches.





Strawberry Banke Museum

www.strawberrybanke.org

Strawberry Banke Museum began as a "save our history" effort by the citizens of Portsmouth. In the late 1950s, Puddle Dock, an area of dilapidated homes near the Piscataqua River, was targeted for urban renewal. All the "substandard" homes in

Puddle Dock -- some of which dated back to the 1600s -- were to be torn down and replaced with modern buildings. That was until city librarian Dorothy Vaughn addressed the Portsmouth Rotary Club one day in 1957. That day Vaughn "laid it on the line" for the Rotary Club, telling them that every time one of the old houses was torn or an antique piece of Portsmouth furniture shipped out of town, the city was losing its past. The Rotary Club was galvanized into action, and while Puddle Dock did undergo urban renewal, much of it has been saved as a historic museum. Named after the earliest Portsmouth settlement, Strawberry Banke Museum, today on the 9.5 acre museum grounds are buildings from four centuries displayed as living history. Each building shows a slice of life from a bygone era, and serious archeological and crafts work continues to be done by staff and artisans on the museum grounds.



Featured Local Restaurants



Three Chimneys Inn
17 Newmarket Rd.
868-7800
www.threechimneysinn.com

Acorn's Restaurant/Café-Lounge
15 Strafford Ave.
862-2815
<http://newenglandcenter.com>



Grant's Cafe

Young's Restaurant
48 Main Street
868-2688
www.youngsrestaurant.com

Other Local Restaurants

The Bagelry

1 Mill Road
868-1424

Stat's Place

11 Madbury Rd.
868-1146

Domino's Pizza

7 Mill Rd. #G
868-6230

Franz's Food

46 Main St.
868-3800

Libby's Bar & Grill

47 Main St.
868-5542

Durham House of Pizza

40 Main St.
868-2224

Murphy's Pub & Restaurant

2 Ballard St.
868-7456

JP's Eatery

38 Main St.
868-7449

Scorpion's Bar & Grill

43 Main St.
389-9084

Excursions

Option 1 June 30 & July 1

Take a trip to Portsmouth, NH to discover the dining and nightlife offerings of the city by the sea. The cost of the excursion is for the transportation from Durham, NH to Portsmouth, NH.

Option 2 July 1

Join us for a sunset cruise aboard the M/V Thomas Lighton, touring The Isles of Shoals. These nine rocky islands are divided along the border of New Hampshire and Maine. The Isles were a key destination for European fishermen before the Pilgrims landed. While out on this 3 hour tour, enjoy Hors D'Oeuvres, refreshments and music. Transportation will be provided from Durham, NH to the boating dock in Portsmouth, NH



About the boat: M/V Thomas Lighton

The Thomas Lighton was named for a famous "Shoaler", politician and businessman. Once keeper of the Isles of Shoals Light, Thomas Lighton later founded the Appledore House of Appledore Island, and formed the beginnings of the resort era at the Isles of Shoals and on the Seacoast.

Things to Do in Portsmouth

Portsmouth Restaurants and Bars:

- ❖ **The Portsmouth Brewery**, for excellent hand-crafted local beers. New Hampshire's first brewpub, founded in 1991, has a nice set of full-time offerings (i.e. core beers) augmented with seasonal beers throughout the year.
www.portsmouthbrewery.com
- ❖ **The Blue Mermaid** to experience the festive and flavorful foods from their wood burning grill. Our award-winning menu features cuisine inspired by the Caribbean Islands. There is always something refreshing to quench your thirst - choose from one of tropical coolers, twelve different margaritas, one of our locally brewed beers on tap or a fine glass of wine from our list. And every weekend, we feature the best in live local music. Open daily for lunch & dinner. Outdoor dining in season. Children's menu and many vegetarian entrees served.
<http://www.bluemermaid.com/>
- ❖ **The Dunaway** is nestled by the west bank of the Piscataqua, a river integral to the maritime history of New England, The Dunaway is serving Contemporary American Cuisine in the heart of a national historic treasure. With the abundance of commercial fishing boats riding the tides, local seafood is prime here, as is excellent regionally sourced land-based fare. In the spirit of traditional cooking, the cuisine draws heavily from fresh, local produce, including historic and rare herbs, fruits and vegetables grown at Strawberry Banke's own working kitchen gardens.
<http://www.dunawayrestaurant.com>

Museums and Galleries:

- ❖ **Arte Toscana Gallery and Sculpture Garden**, their mission is to bring the works of talented Tuscan artists to the attention of American collectors. The Gallery is at 112 State Street, Portsmouth, New Hampshire. (603) 433-6002 or visit www.arte-toscana.com
- ❖ **Seacoast Gallery** has been designed in a casual and eclectic atmosphere where patrons enjoy wandering through this unique gallery and viewing a range of art mediums including hand blown and leaded glass, blacksmithing, sculptures, photography, furnish 371 Islington St, Portsmouth, NH 03801
Phone: 603-766-0390

- ❖ **The Portsmouth Athenaeum** is a non-profit membership library and museum, incorporated in 1817 and located in the heart of historic Portsmouth, New Hampshire. 6-8 Market Square, Portsmouth, NH 03801
Phone: 603-431-2538
www.portsmouthathenaeum.org
- ❖ **Historic New England** is the oldest, largest, and most comprehensive regional preservation organization in the country. We offer a unique opportunity to experience the lives and stories of New Englanders through their homes and possessions. 143 Pleasant St., Portsmouth, NH 03801
Phone: 603-436-3205
www.historicnewengland.org

Live Music:

- ❖ **The Red Door** is a chic and cozy martini bar with live entertainment almost every day of the year. 107 State Street, Portsmouth, NH 03801
Phone: 603-373-6827
www.reddoorportsmouth.com
- ❖ **The Music Hall**, built in 1878, the oldest theater in New Hampshire is a non-profit performing arts center featuring acclaimed film, music, theater, and dance. The Music Hall Historic Tour focuses on the recent stunning restoration of the dome and proscenium arch. 28 Chestnut St., Portsmouth, NH 03801
Phone: 603-436-2400
www.themusic hall.org